



**A cost-effective 24/7 structural health monitoring system for buildings and bridges that ensures economical and hassle-free compliance. Be truly prepared for THE BIG ONE!**

**Together, let's invest and usher a safer and more resilient world.**

**Economical and hassle-free compliance!**

**Proudly Filipino, made by Mapua Scientists and Engineers**

Universal Structural Health Evaluation and Recording System (USHER) is a building structure health monitoring system composed of an accelerometer / sensor web portal system. The patent-pending technology can be installed in buildings of all types, allowing building managers to monitor the structural integrity of the building, and ensure economical and hassle-free compliance with Philippine government regulators. Unlike existing products, USHER has streamlined and tailored the system to the local market, making it remarkably lower in cost while still offering a complete solution to ensure business continuity.

## Features of the USHER System

### USHER Sensor Device

System includes a locally made and cost-effective structural health and earthquake recording instrument

- Easy to install
- Cost-effective
- Low maintenance
- Locally fabricated
- Parts are readily available
- Design specification based on DPWH guidelines

### USHER Portal

**Allows remote monitoring of your building's structural health**

- Provides a decision-support tool for building owners, structural engineers, LGU building officials, and the DPWH

- Wireless data retrieval, storage, archiving
- 24/7 data access
- Alarm system (e.g. SMS, email)
- Automatic data interpretation based on set thresholds
- Public Announcement (PA) system-ready

### End to End Service and Technical Support

- Pre-assessment of buildings
- Installation and certification
- Post-assessment of buildings
- Annual data interpretation and report
- Annual building certification
- 24/7 technical support

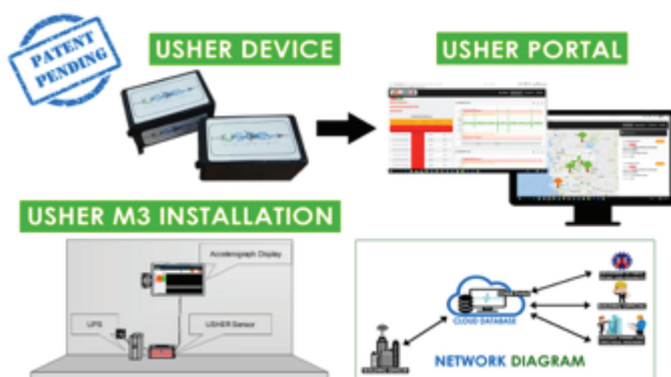

### Contact:

**Francis Aldrine A. Uy, PhD**  
Project Leader  
School of Civil, Environmental and  
Geological Engineering  
Mapua University

+63 9178030779 / +63 9989637675  
faaay@mapua.edu.ph

